

MEASUREMENT:	0.5-6mm	6-30mm	30-120mm	120-300mm	300-1000mm	1000+mm
TOLERANCE (+/-):	0.2mm	0.5mm	0.8mm	1.0mm	1.5mm	2.0mm
SPECIAL TOLERANCES:	WILL BE SHOWED ON THE DOCUMENT IT SELF.					

LWD-C Mil-C-17F RG213U 50Ω

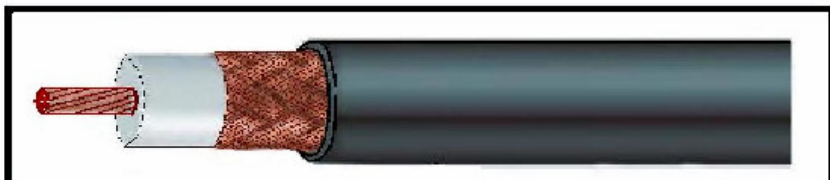
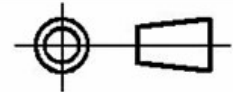

MOVEMENT SPECIFICATION:

1. Cut a length of 100mm of the cable.
2. Strip on each end 20mm to expose 10mm bare dielectric and 10mm of the shield.
3. No movement must be possible inside the PVC jacket or on the dielectric using reasonable force.
4. No movement of inner conductor inside dielectric must be possible.

TECHNICAL SPECIFICATIONS:

Inner Conductor	- 7 X 0.52mm Bare Copper
Insulation Dielectric	- 7.24mm Solid Polyethylene
Overall Outer Braid	- 24 X 8 = 192 Bare Copper Strands (95%)
Jacket	- 10.29mm Black PVC X 1.3Mmm Thickness
Overall Diameter	- 10.3mm
Weight	- 29 gram/m or 160 Kg/km
Impedance	- 50 Ohms
Velocity Factor	- 66%
Capacitance, Nominal	- 101 pF/m
Attenuation 1 MHz.	- 0.33 dB/100m
Attenuation 10 MHz.	- 0.65 dB/100m
Attenuation 50 MHz.	- 1.24 dB/100m
Attenuation 100 MHz.	- 6.20 dB/100m
Attenuation 200 MHz.	- 9.14 dB/100m
Attenuation 400 MHz.	- 13.70 dB/100m
Attenuation 700 MHz.	- 19.25 dB/100m
Attenuation 900 MHz.	- 22.51 dB/100m
Attenuation 1000 MHz.	- 23.85 dB/100m
Attenuation 4000 MHz.	- 76.35 dB/100m

PRINTING SPECIFICATION:

LWD-C MIL-C-17F RG213U 50Ω

NOTES:

1. PRINTING TO BE WHITE ON BLACK SLEEVING
2. PRINTING TO BE REPEATED EVERY 300mm
3. FONT TO BE USED IS "ARIAL ROUNDED MT BOLD"
4. ■ LOGO TO BE TO COMANY SPECIFICATION.